



# ASPIRE

— TO MOVE —



## Laura Place, Bath, BA2

Great city central studio flat located on Laura Place, Bath. The property is offered furnished and is available from the 2nd July. Professional or students considered.

Laura Place is located at the beginning of the world famous, Great Pulteney Street. The location gives access to local amenities on Pulteney Bridge and access to the city centre thereafter. The central location provides great access to the University of Bath which is a 10 minute bus ride.

- Studio flat
- Available 2nd July
- Furnished
- City central location
- Council tax band: A
- Holding deposit: £265
- Assured Periodic Tenancy

**£1,150 PCM**

BASEMENT  
440 sq.ft. (40.9 sq.m.) approx.

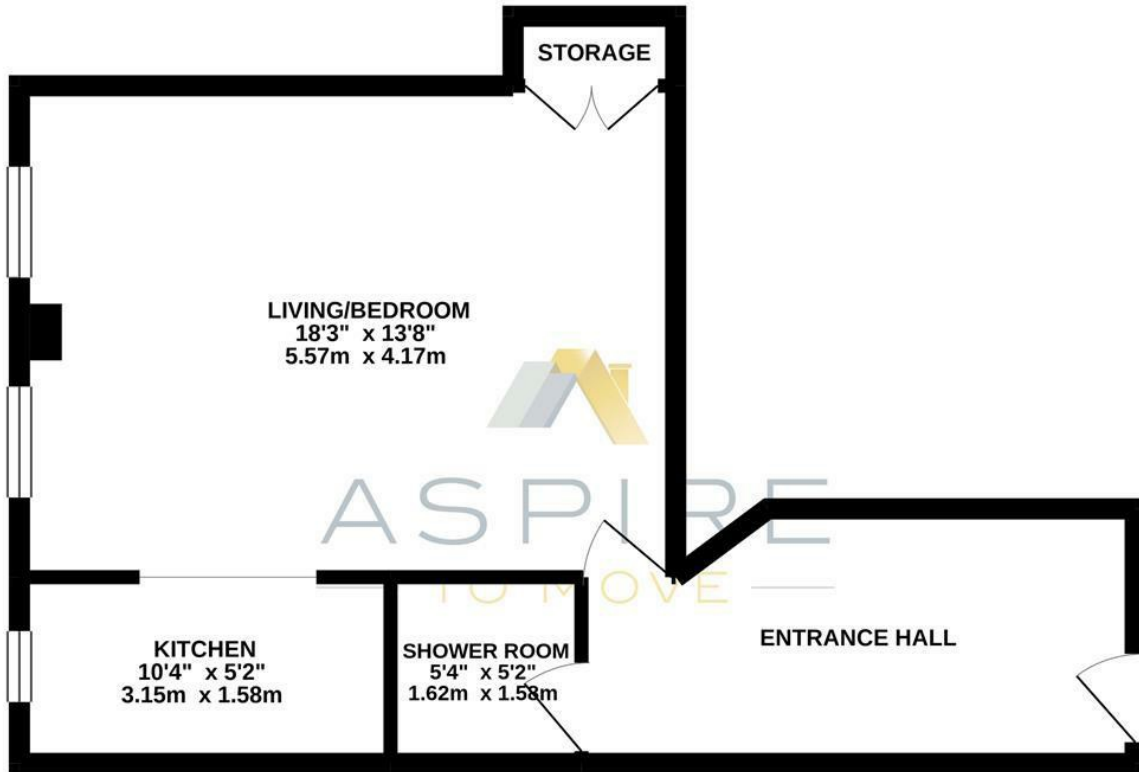

7 LAURA PLACE

TOTAL FLOOR AREA : 440 sq.ft. (40.9 sq.m.) approx.

Whilst every attempt has been made to ensure the accuracy of the floorplan contained here, measurements of doors, windows, rooms and any other items are approximate and no responsibility is taken for any error, omission or mis-statement. This plan is for illustrative purposes only and should be used as such by any prospective purchaser. The services, systems and appliances shown have not been tested and no guarantee as to their operability or efficiency can be given.  
Made with Metropix ©2020

Energy Performance Graph

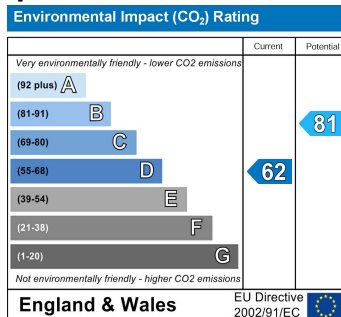
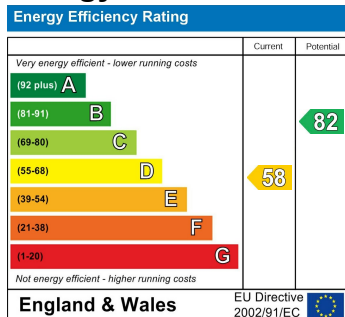

These particulars, whilst believed to be accurate are set out as a general outline only for guidance and do not constitute any part of an offer or contract. Intending purchasers should not rely on them as statements of representation of fact, but must satisfy themselves by inspection or otherwise as to their accuracy. No person in this firm's employment has the authority to make or give any representation or warranty in respect of the property.